

S164-RTV1S/4/11

A	B	C	D	
1	S116-003	1096	346	1/1
2	S116-105A	336	460	1/1
3	S116-106A	336	460	1/1
4	S116-203A	1100	480	1/1
5	S116-204A	1100	460	1/1
6	S116-402A	1067	120	1/1
7	S116-504	400	160	1/1
8	S116-505	400	160	1/1
9	S116-506	1027	146	1/1
10	S116-903	1077	346	1/1
11	S116-904	1037	406	1/1

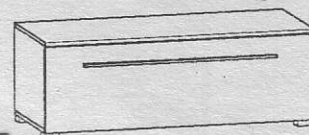

LM INTERIER

www.lm-interier.cz

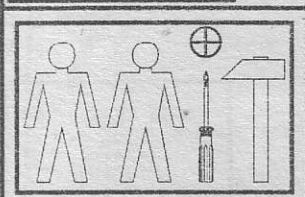
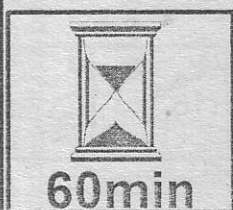
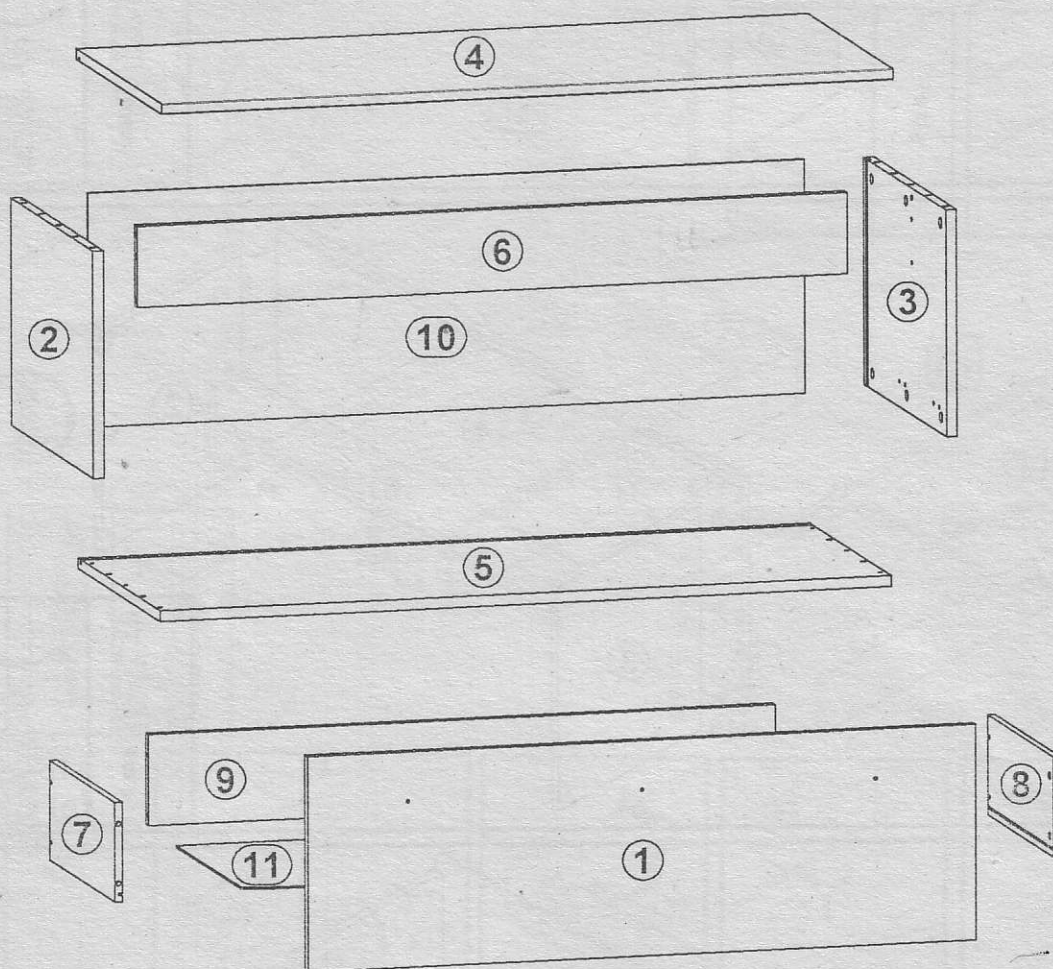

1x c25316	8x e3	10x f1	4x f25	4x k55	1x p25	1x p35	4x p38	8x p6
3x p9	16x r1	4x r15	20x r16	2x s2	1x t33	1x w78/L	1x w78/P	2x o21
10x l2								

1

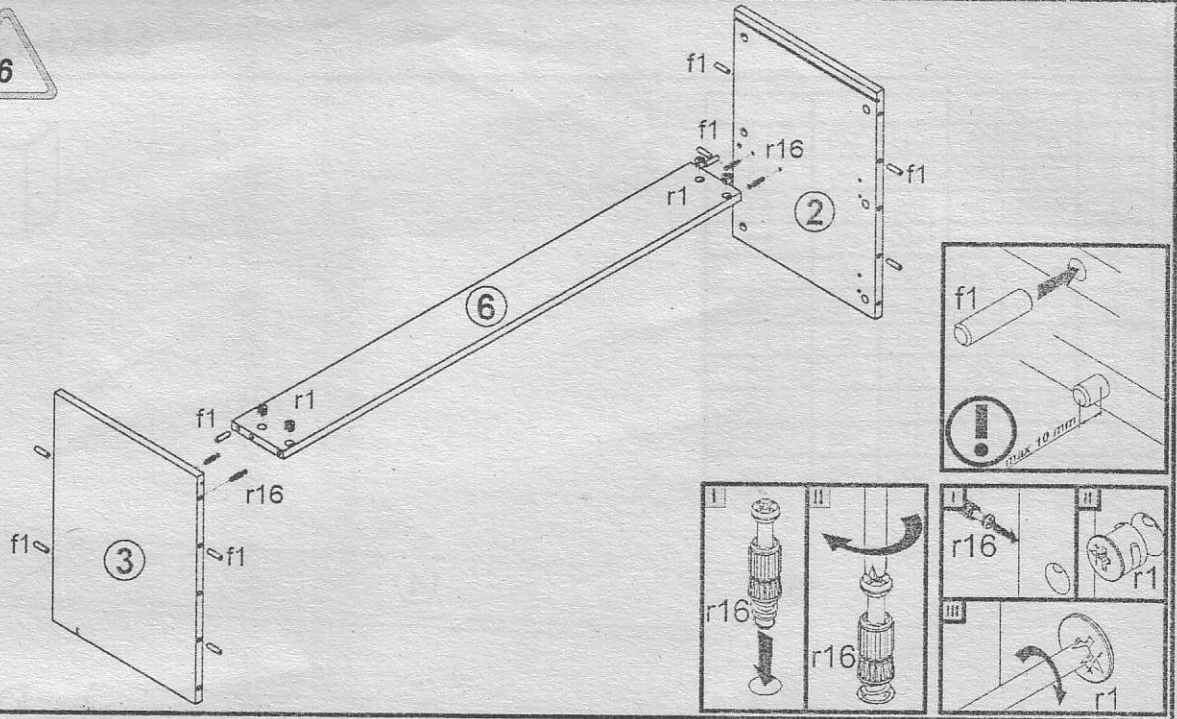

2

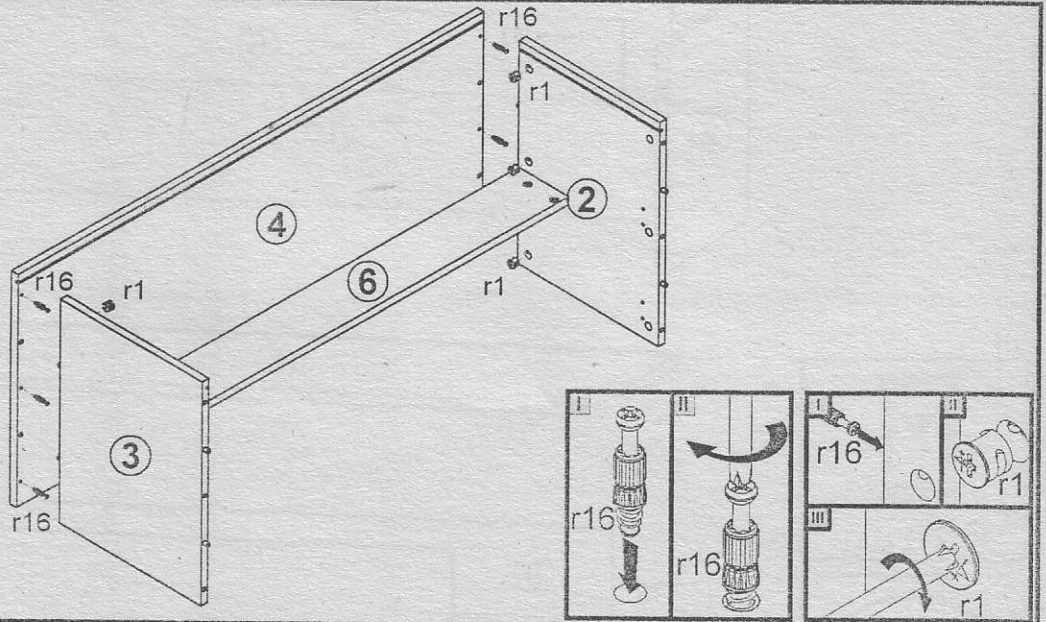

3

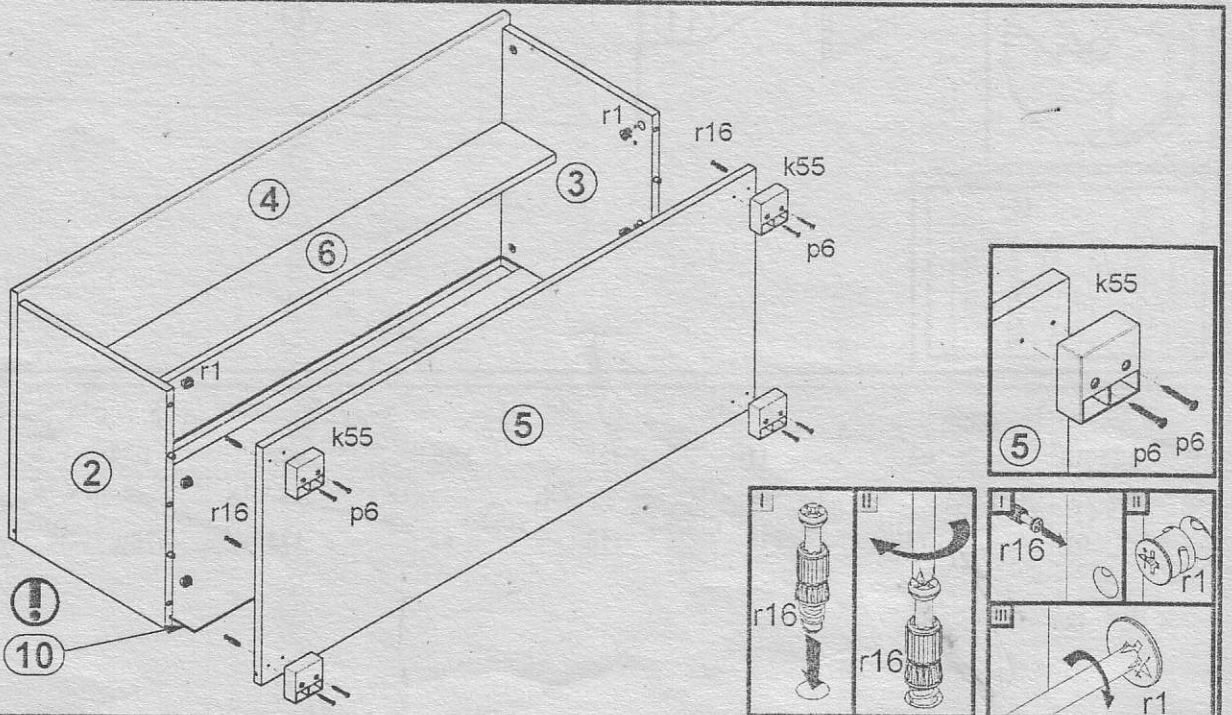

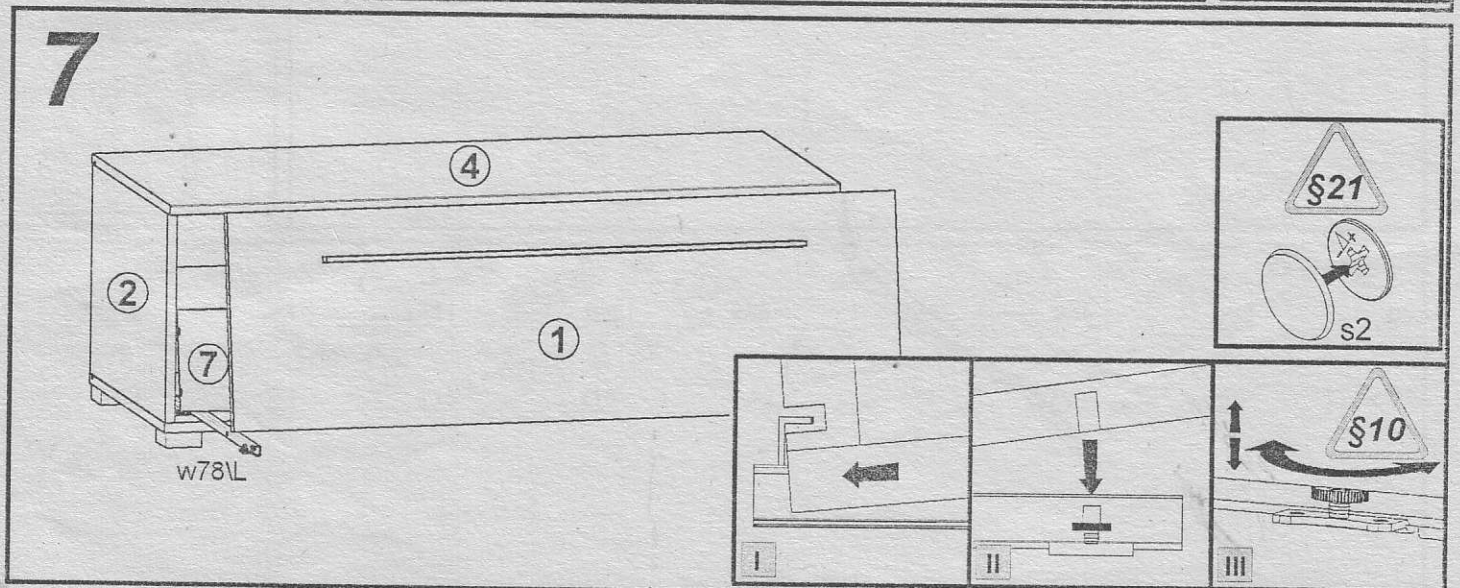
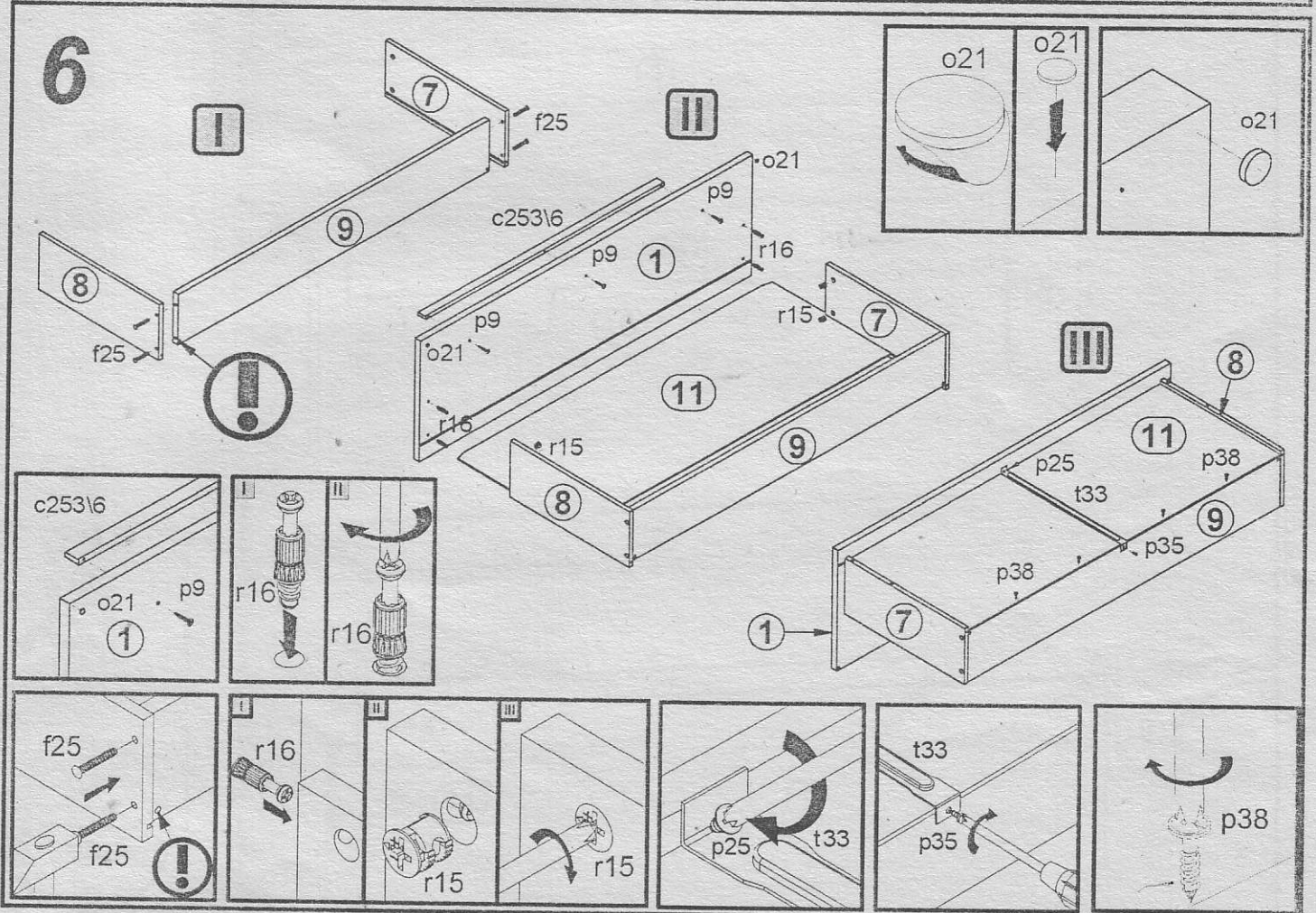
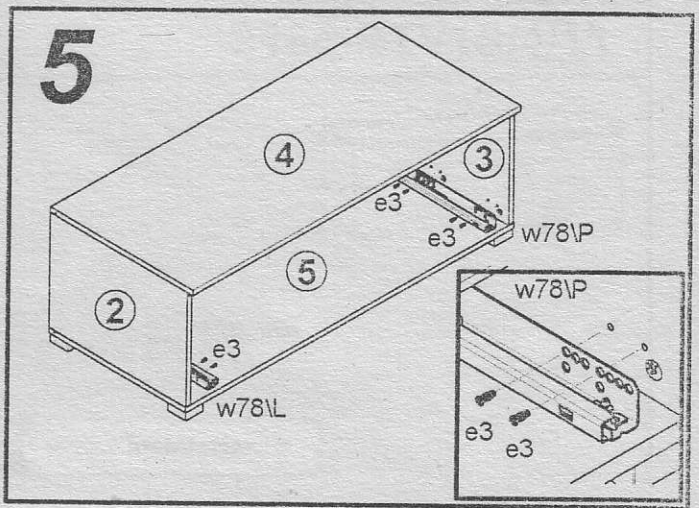
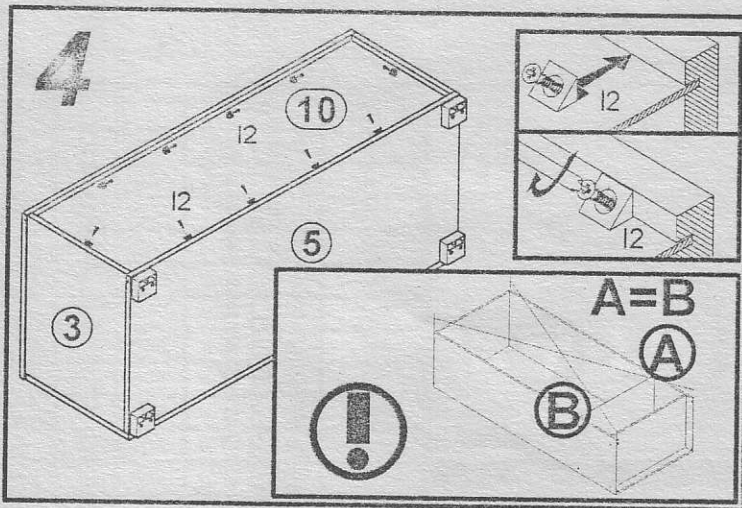

S164-RTV2S/4/12

A	B	C	D	
1	S116-101A	336	460	1/1
2	S116-102A	336	460	1/1
3	S116-103A	130	440	1/1
4	S116-104A	190	440	1/1
5	S116-201A	1200	480	1/1
6	S116-202A	1200	460	1/1
7	S116-301A	1167	440	1/1
8	S116-501	400	100	1/1
9	S116-502	400	100	1/1
10	S116-503	535	86	1/1
11	S116-901	1177	346	1/1
12	S116-902	543	406	1/1
13	S164-007	596	158	1/1
14	S164-008	596	158	1/1
15	S164-401	1196	60	1/1

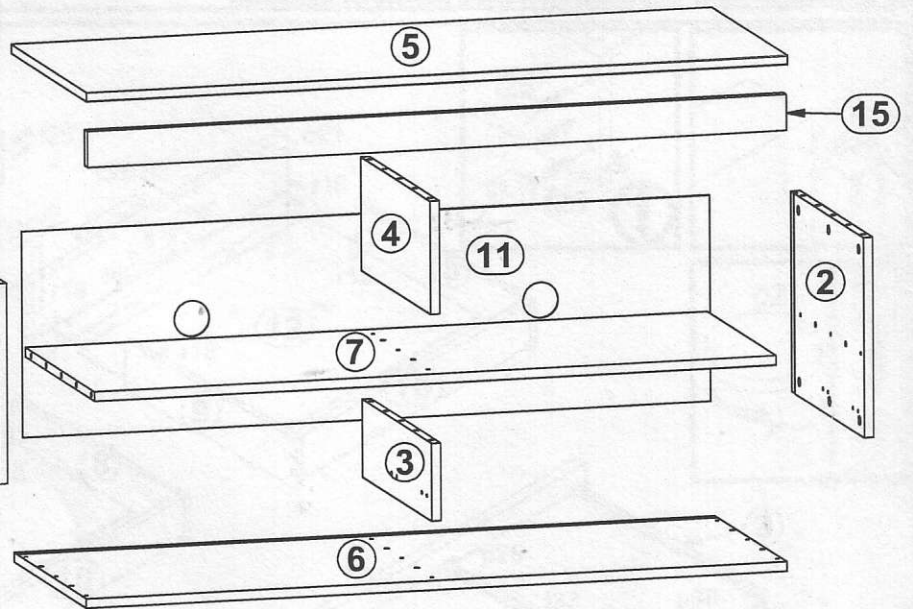
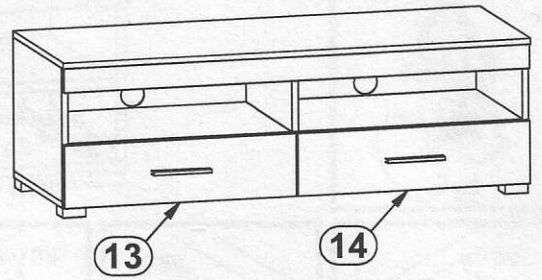

90 min

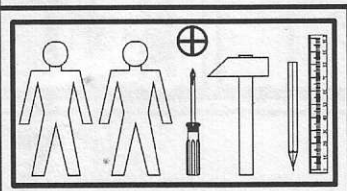
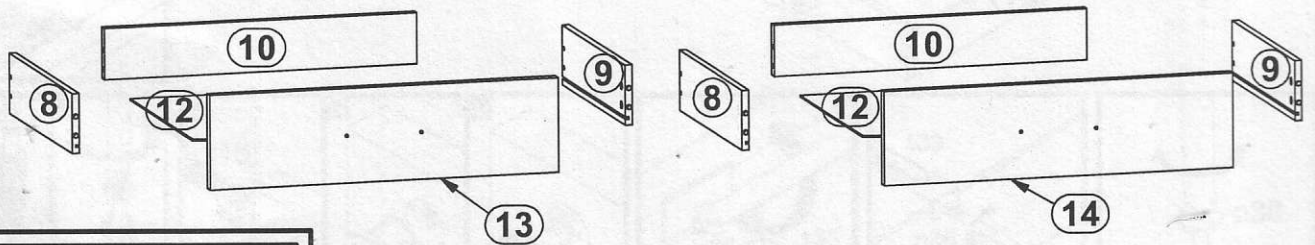

2x c25313	16x φ6x13 mm e3	24x φ8x30 mm f1	8x φ6.5x40 mm f25	5x k55	20x l1	2x φ3.5x16 mm p25	2x φ3.5x10 mm p35	4x φ3.5x16 mm p38
10x φ4x35 mm p6	4x φ4x30 mm p9	34x φ1.5x12mm #16 r1	8x φ12x10.5mm #12 r15	42x r16	3x ø16 s2	4x silikon o21	2x 400 mm t33	2x 400 mm w78/L
2x 400 mm w78/P	12x l2							

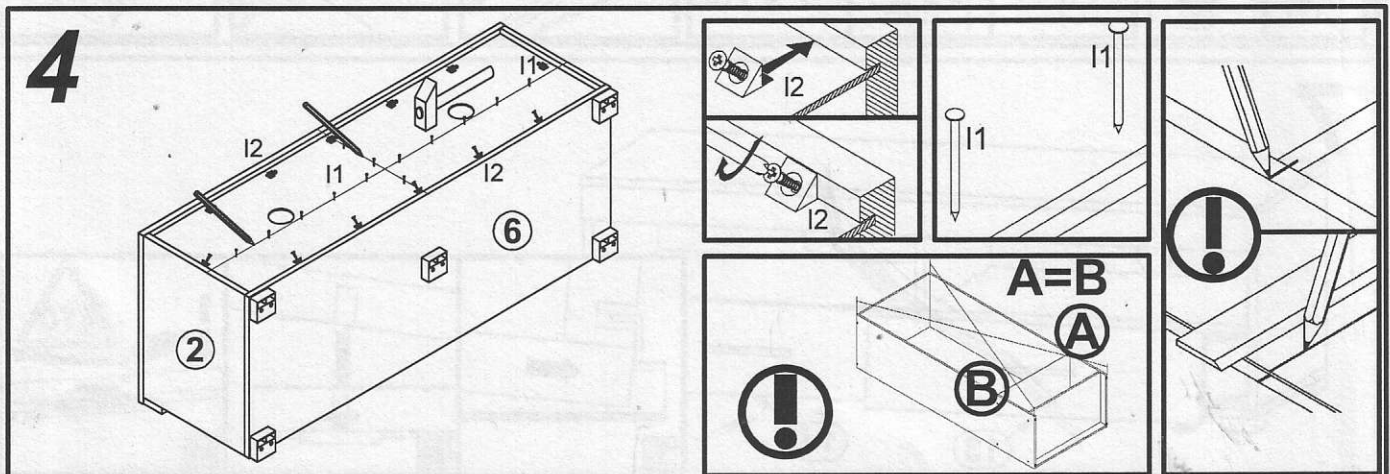
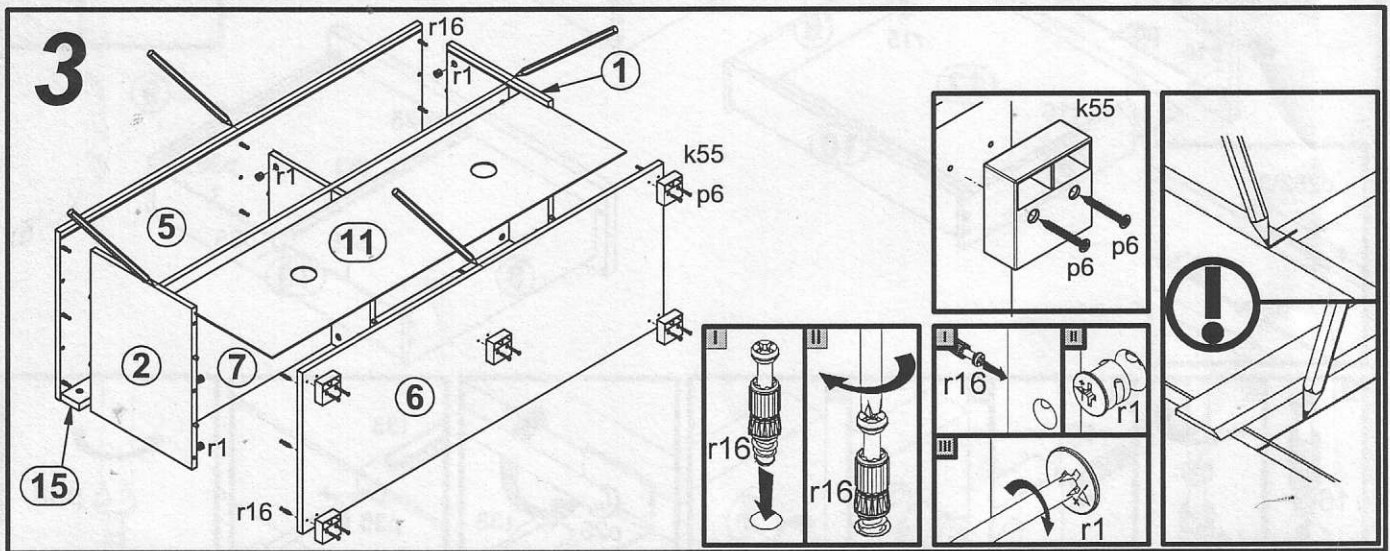
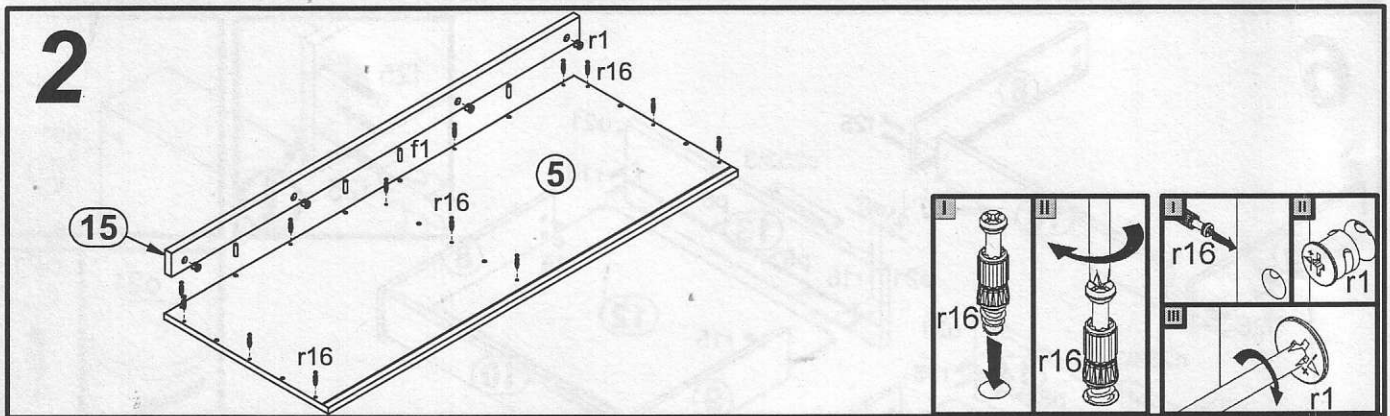
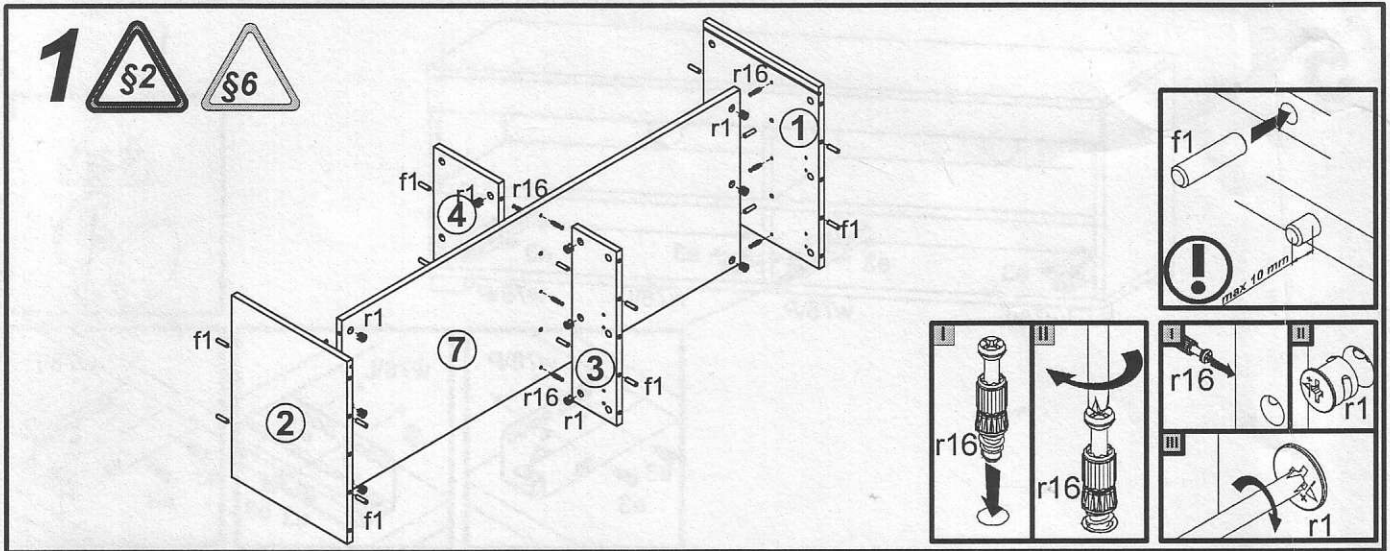

5

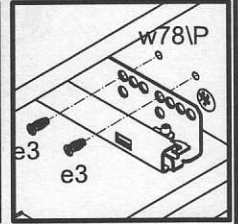
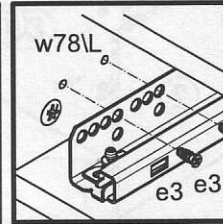
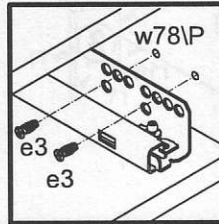
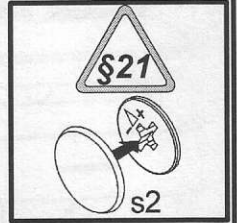
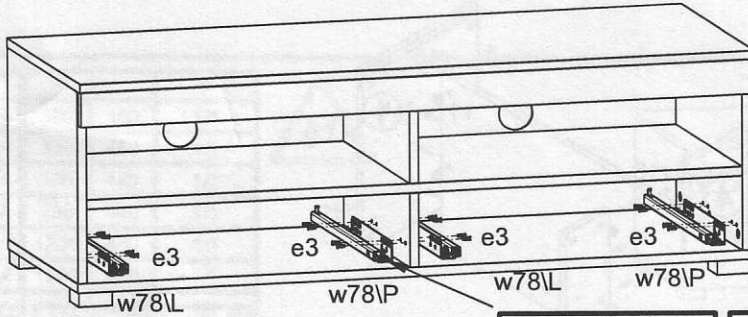

6

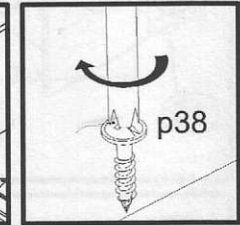
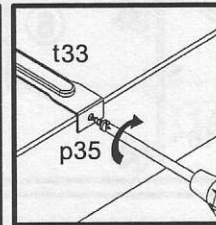
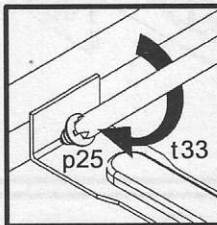
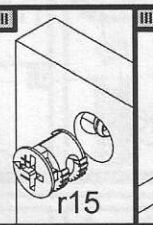
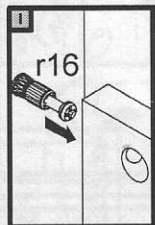
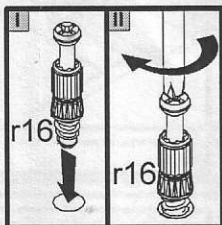
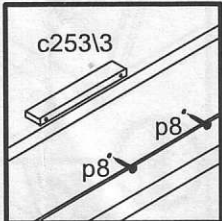
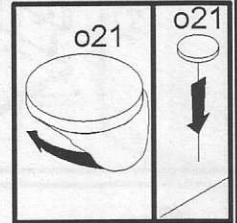
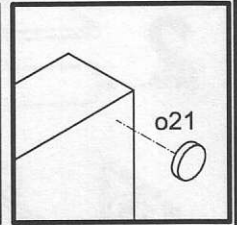
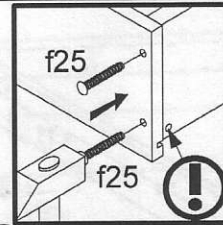
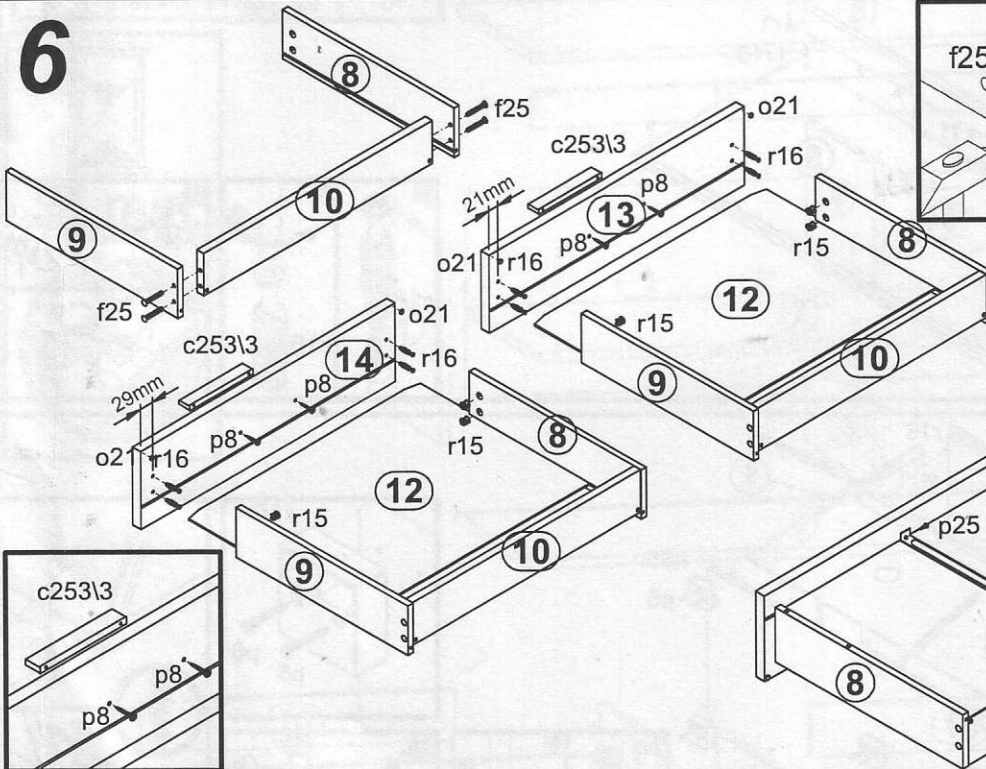

7

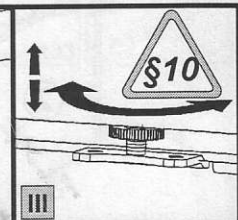
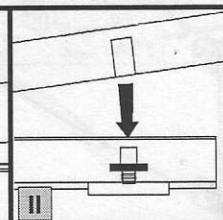
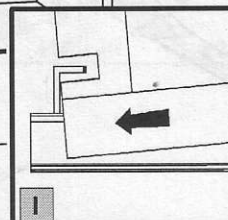
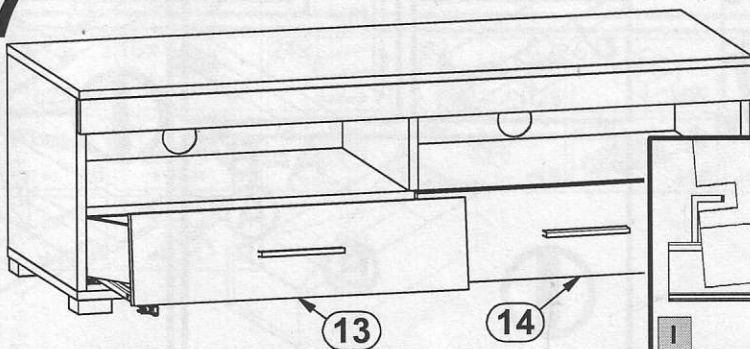

10 31 NN 40

S116-P/1/10

S164-P/1/10

A	B	C	D
1	S116-309	950	230
2	S116-404	950	120

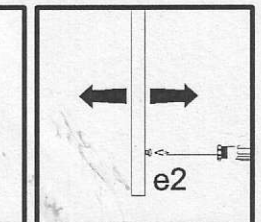
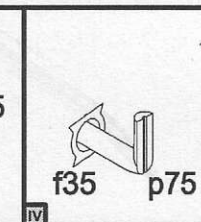
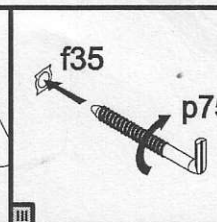
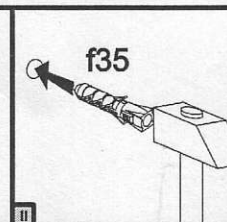
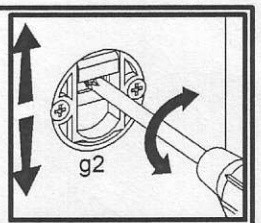
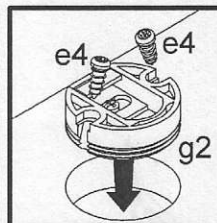
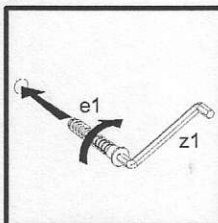
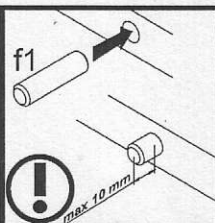
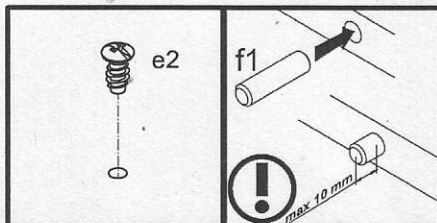
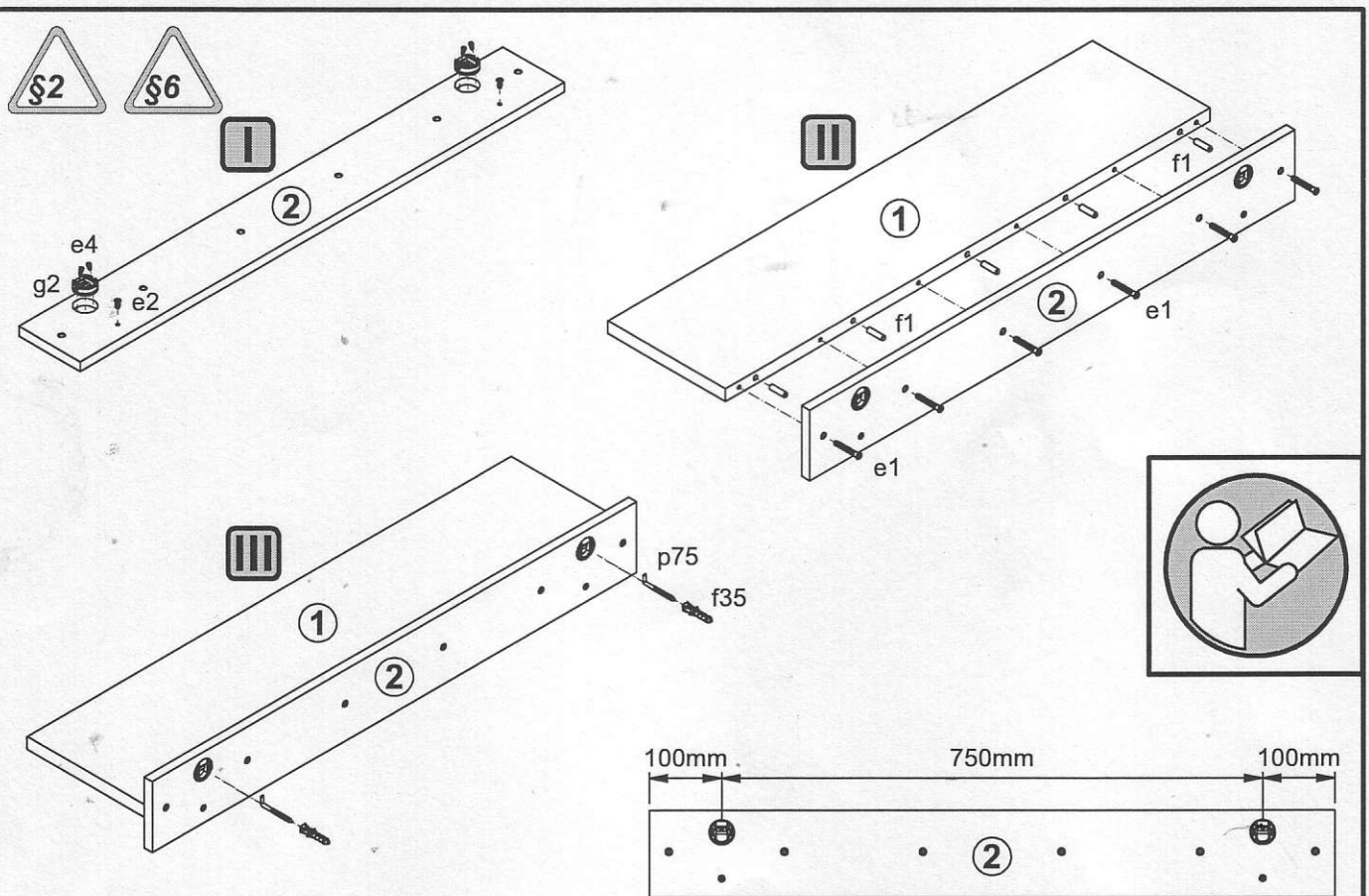
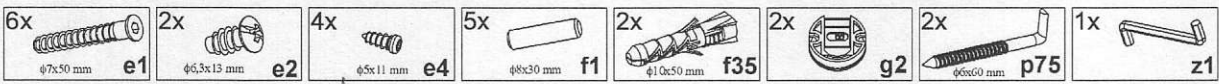
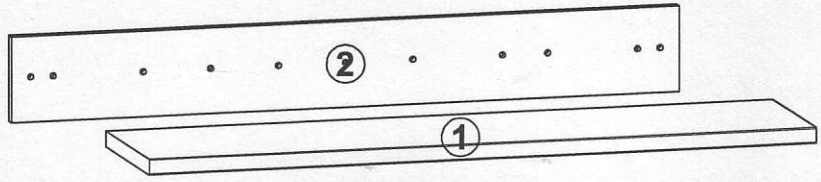
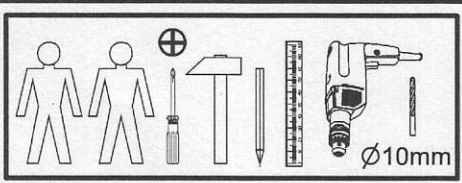

S164-SFW1W1D/11/10L

A	B	C	D	
1	S164-004	596	1050	2/2
2	S116-107	1022	330	1/2
3	S116-108	1022	330	1/2
4	S116-109	1022	310	1/2
5	S116-205	950	330	1/2
6	S116-206	950	330	1/2
7	S116-302	325	280	1/2
8	S116-303	575	310	1/2
9	S116-907	1032	339	2/2
10	S116-908	1032	588	2/2
11	S164-005	1050	346	2/2
12	qb30\2			1/2

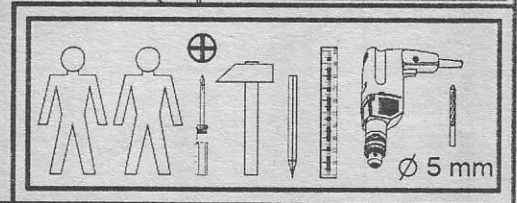
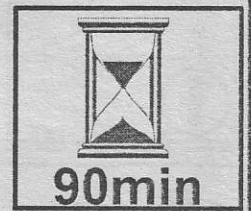
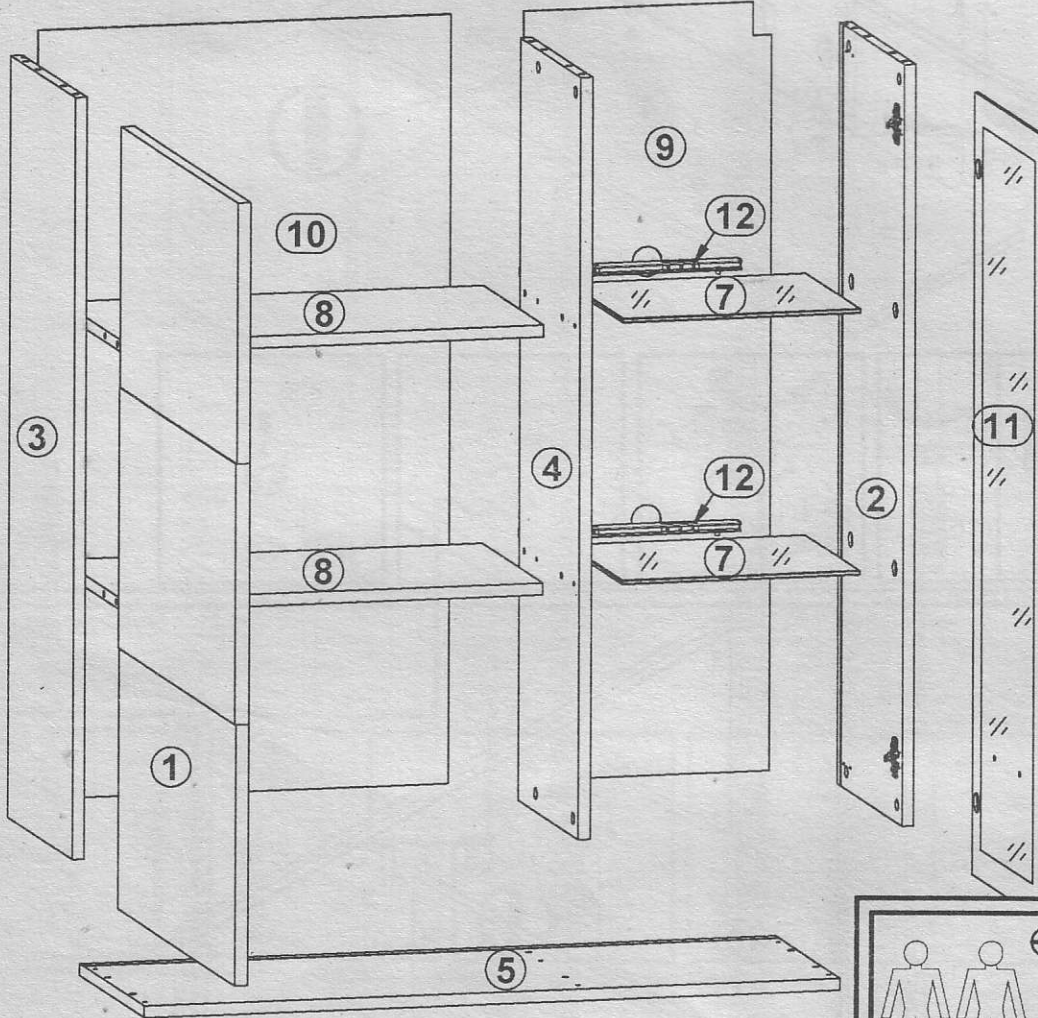
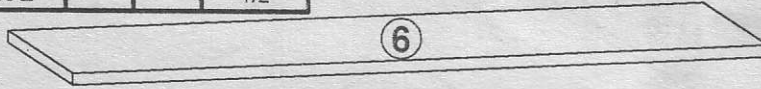
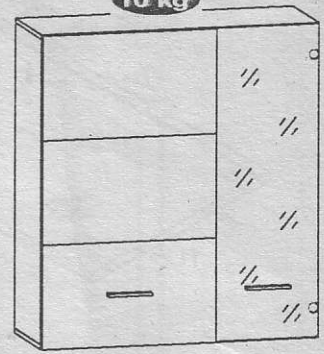

3x a2	2x a42\11	3x b1	2x b2	2x c253\13	8x d23	8x ø6.0x11 mm e36	20x ø6x50 mm f1	2x ø10x50 mm f35
30x l1	10x l2	1x n38\L	1x n38\P	2x ø14x6 mm o21	2x ø2.5x10x1.2 mm o27	2x o43\7	4x ø4x30 mm p21	4x ø2.5x10 mm p53
2x ø4x12 mm p59	2x ø6x50 mm p75	2x ø4x30 mm p9	20x ø1.5x12 mm +1e r1	20x r16	18x ø16 s2	2x s53	2x a42\4	2x a42\5

1 §2

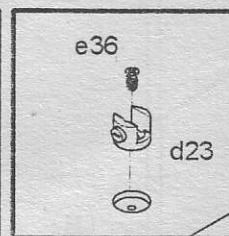
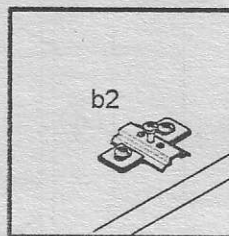
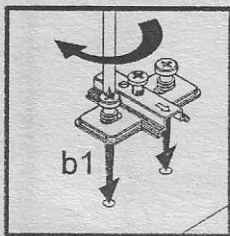
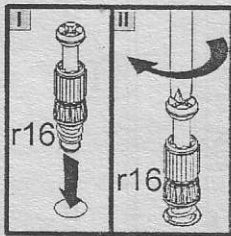
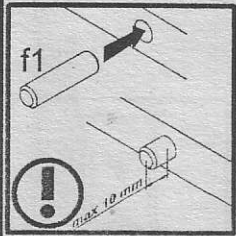
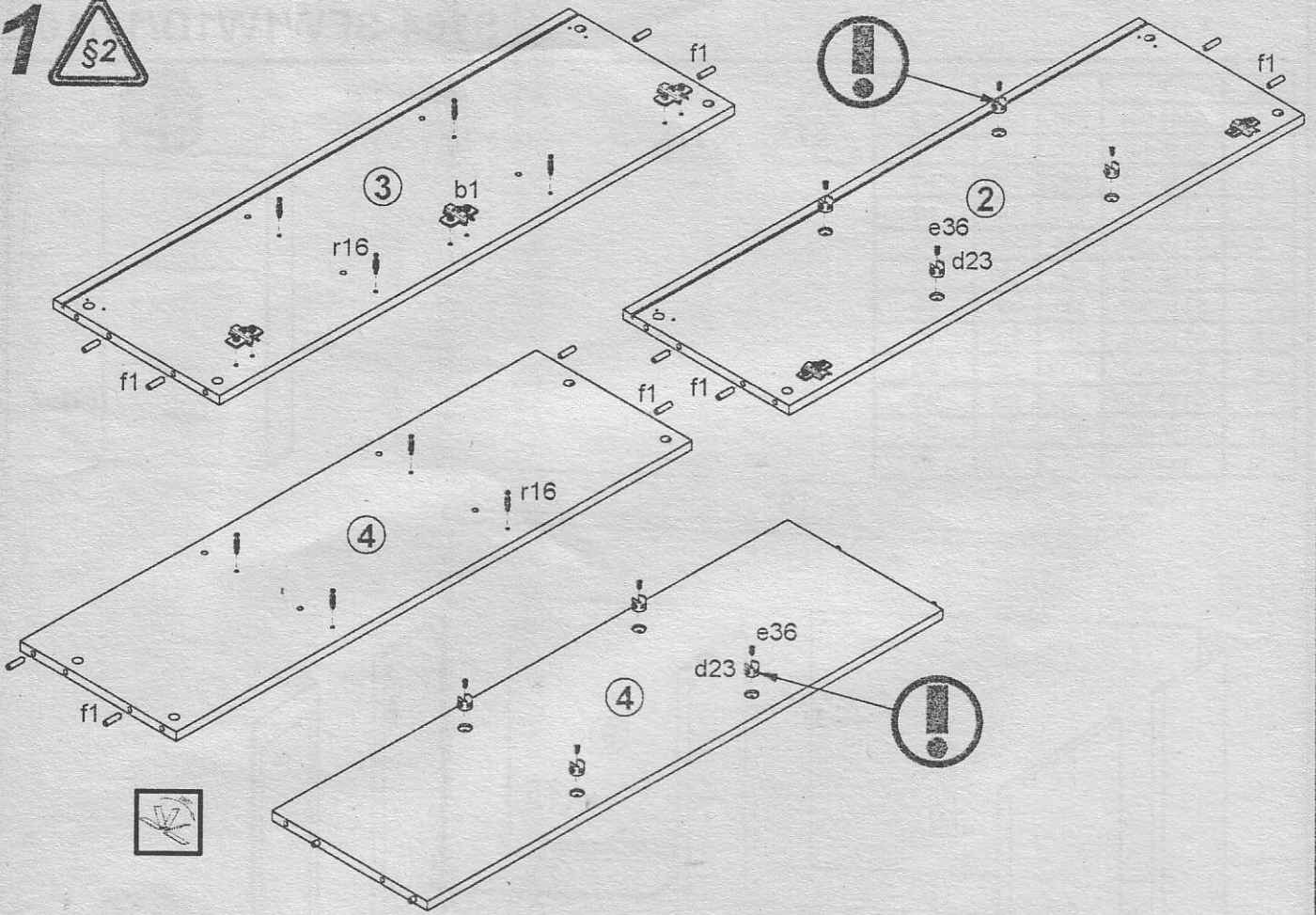

2 §6

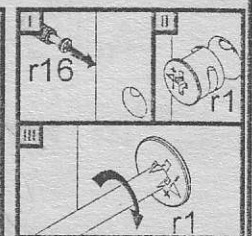
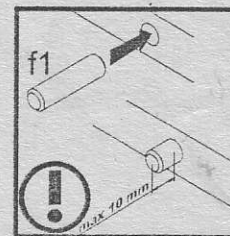
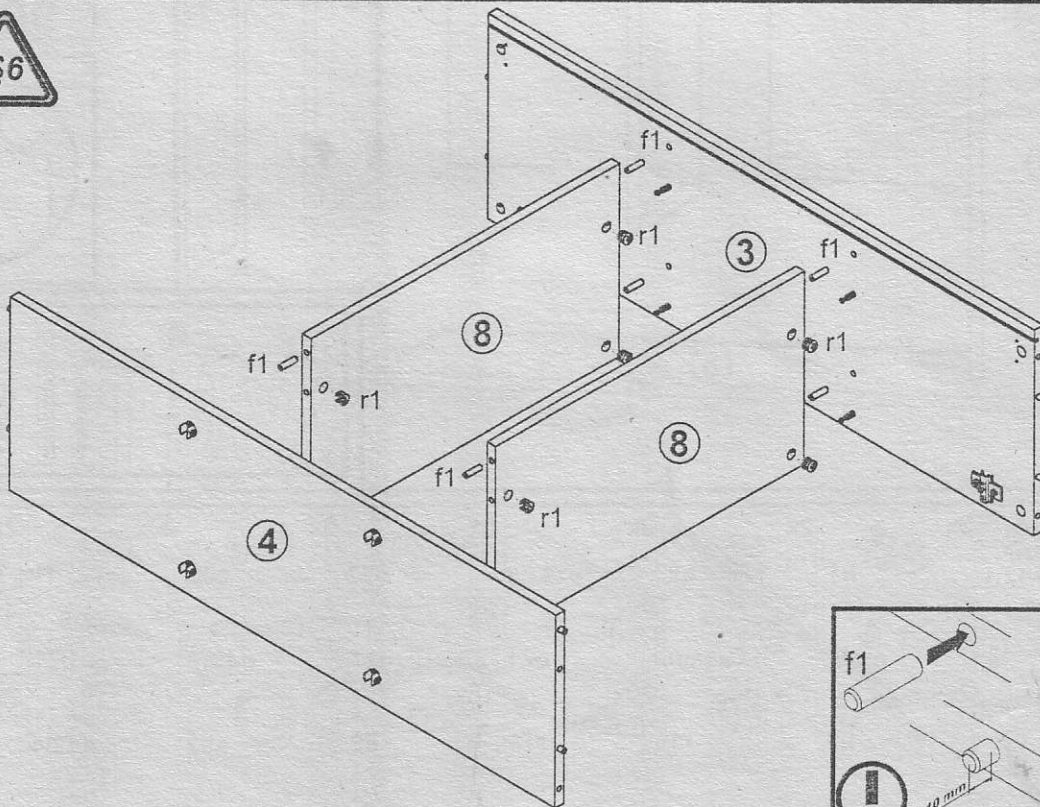

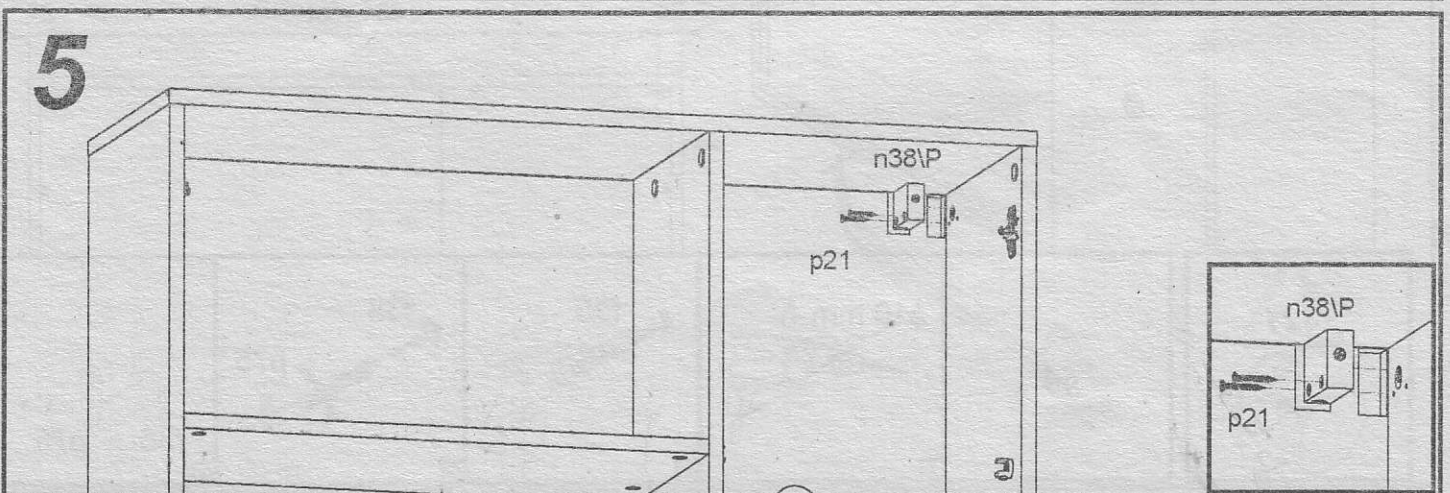
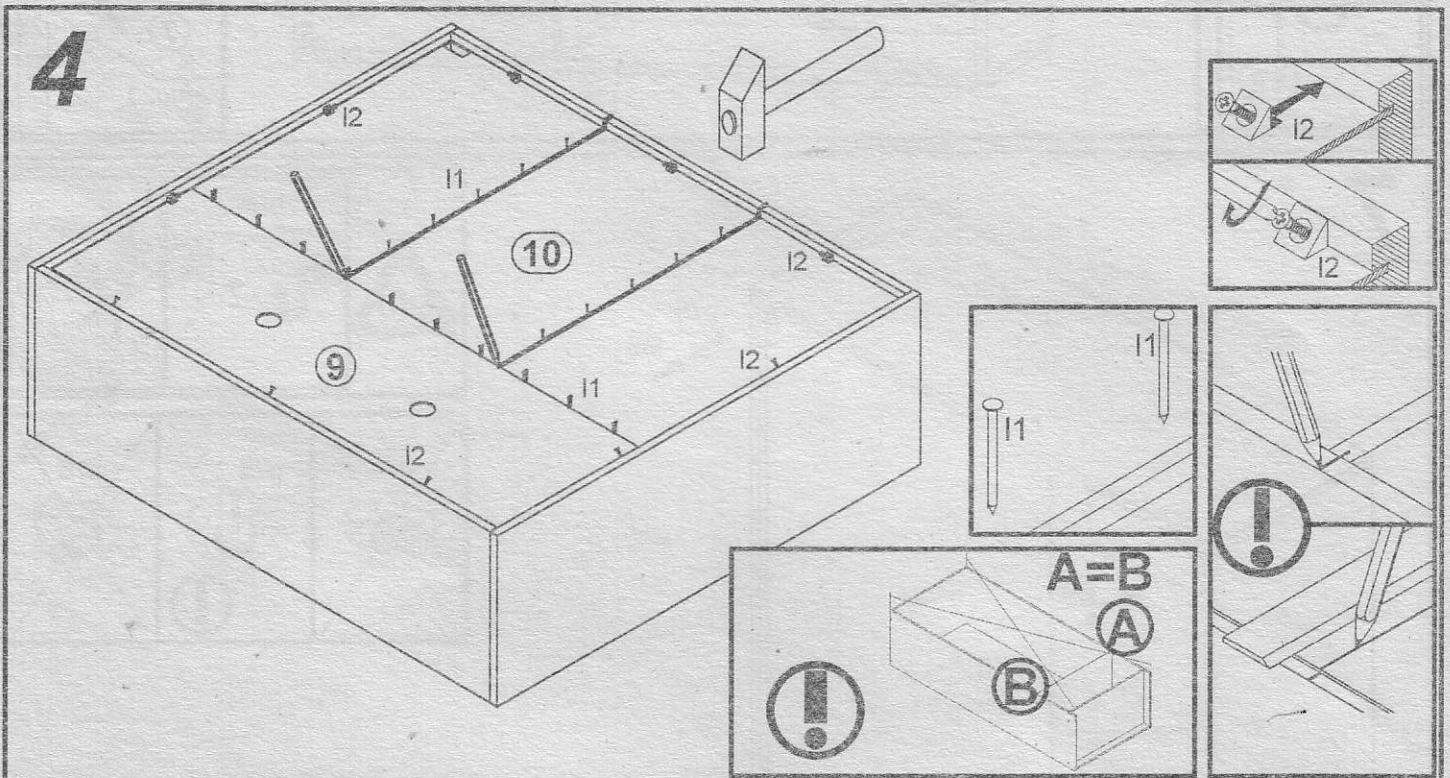
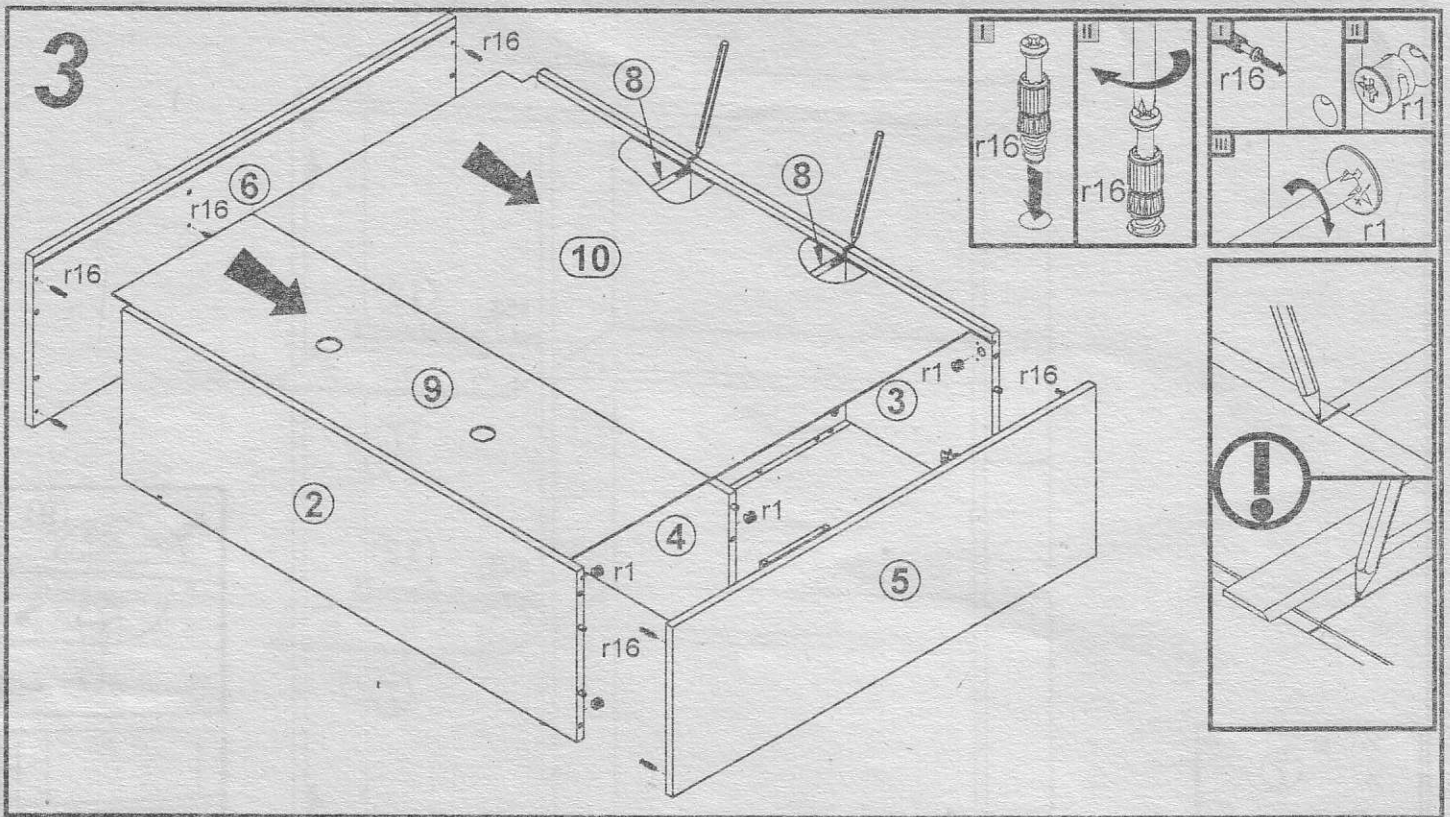

6

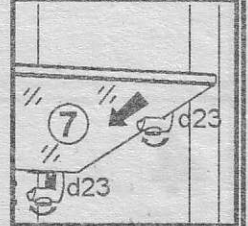
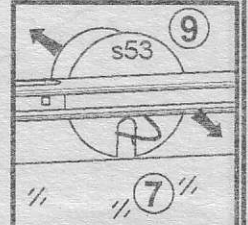
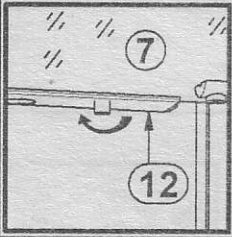
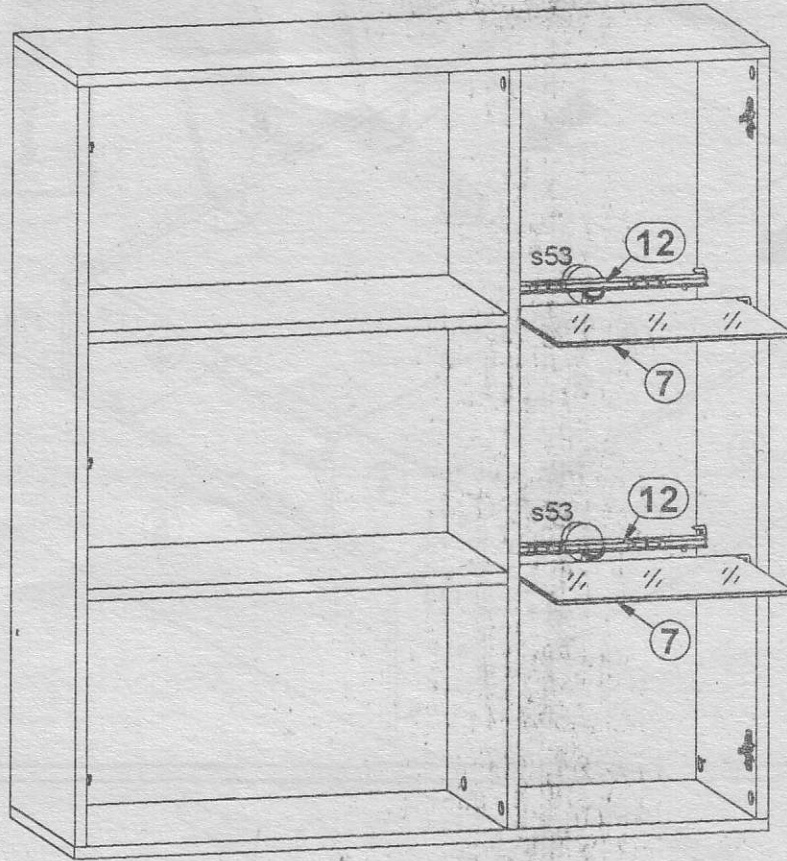

7

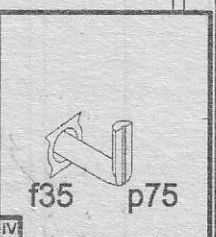
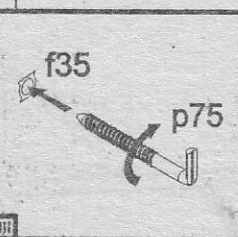
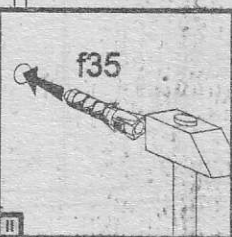
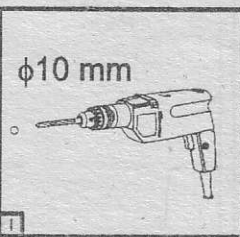
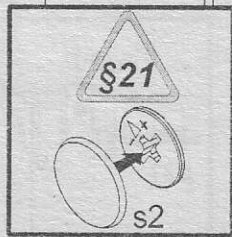
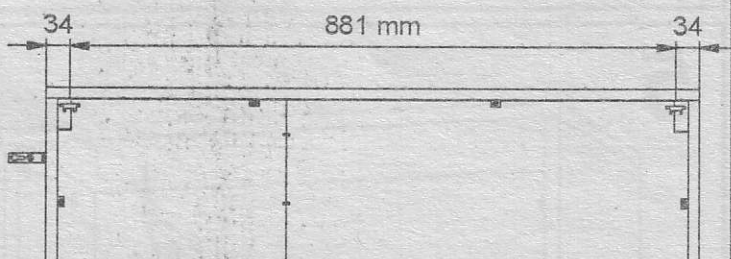
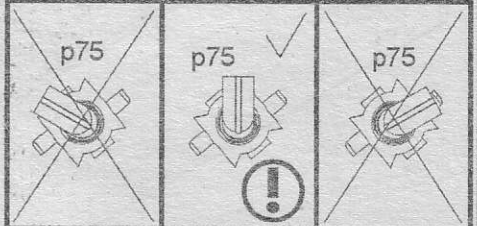
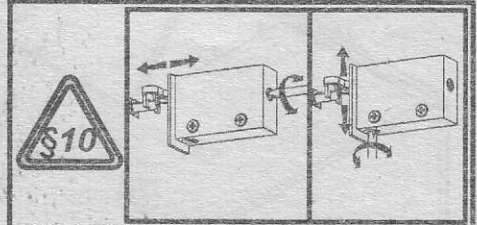
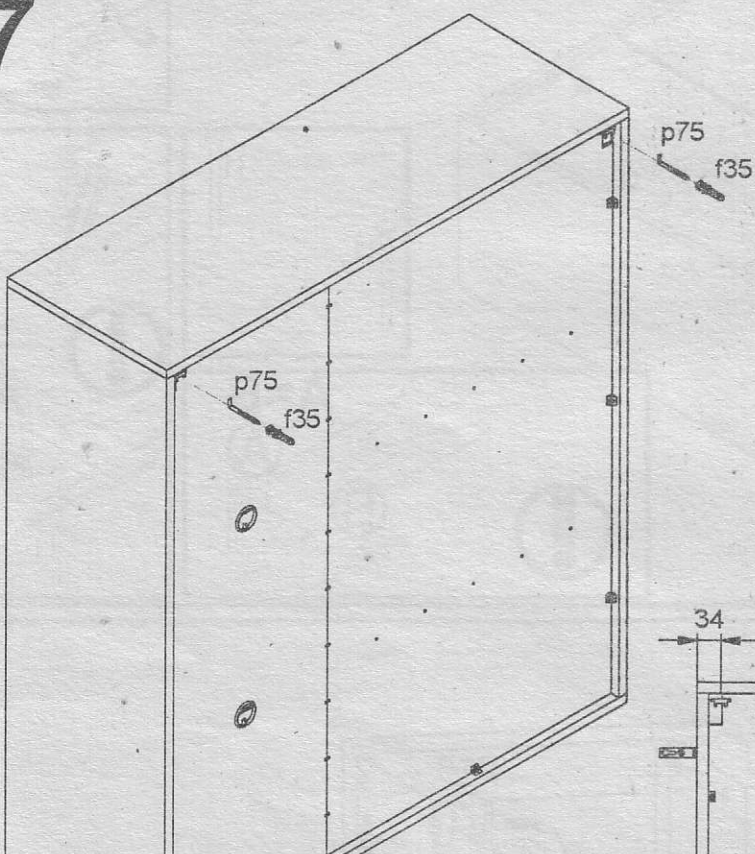

8

§11

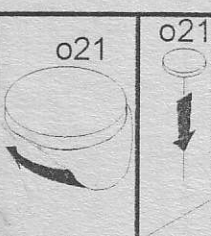
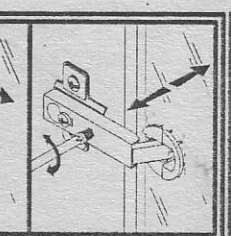
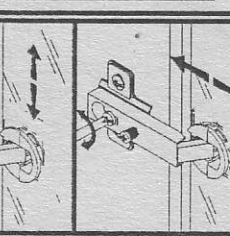
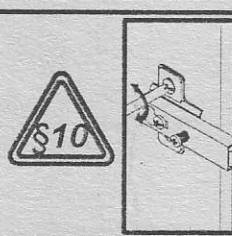
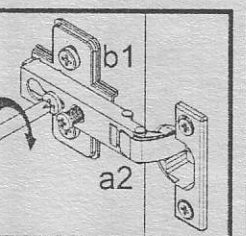
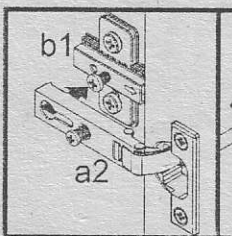
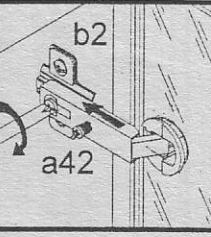
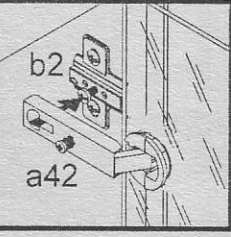
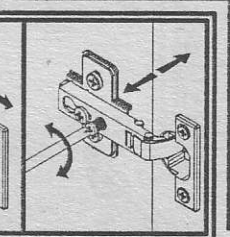
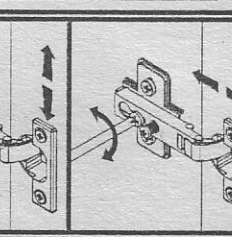
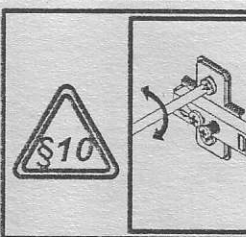
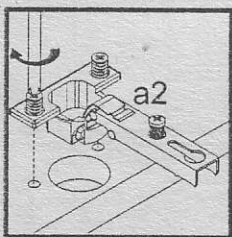
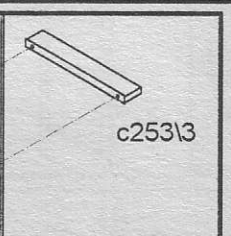
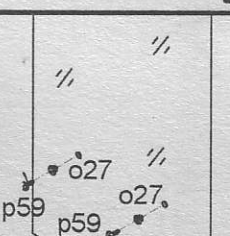
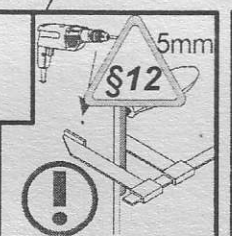
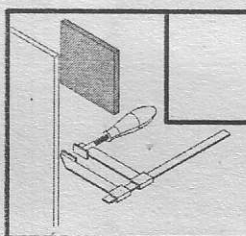
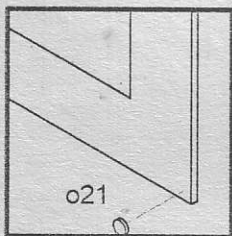
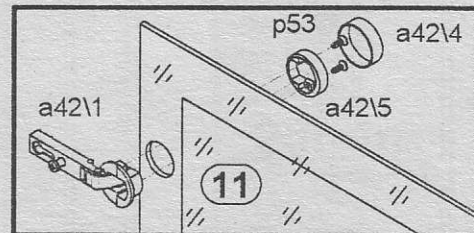
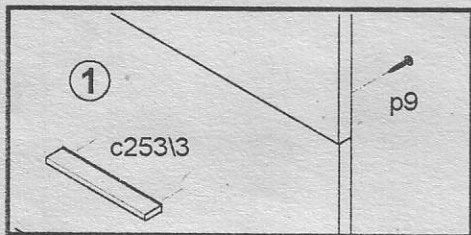
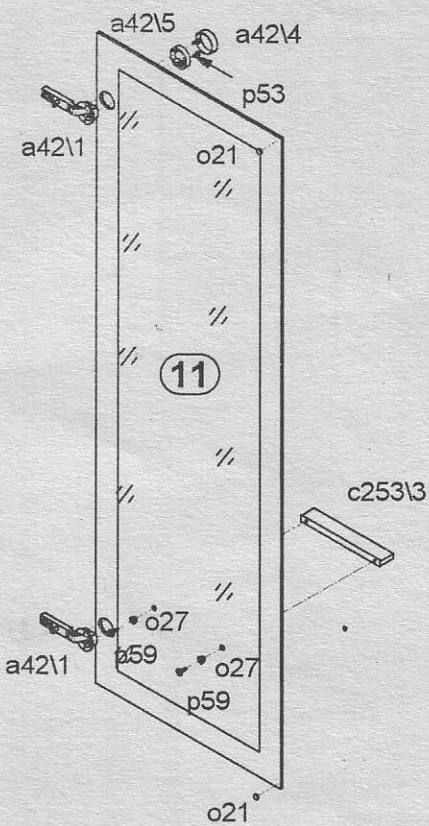
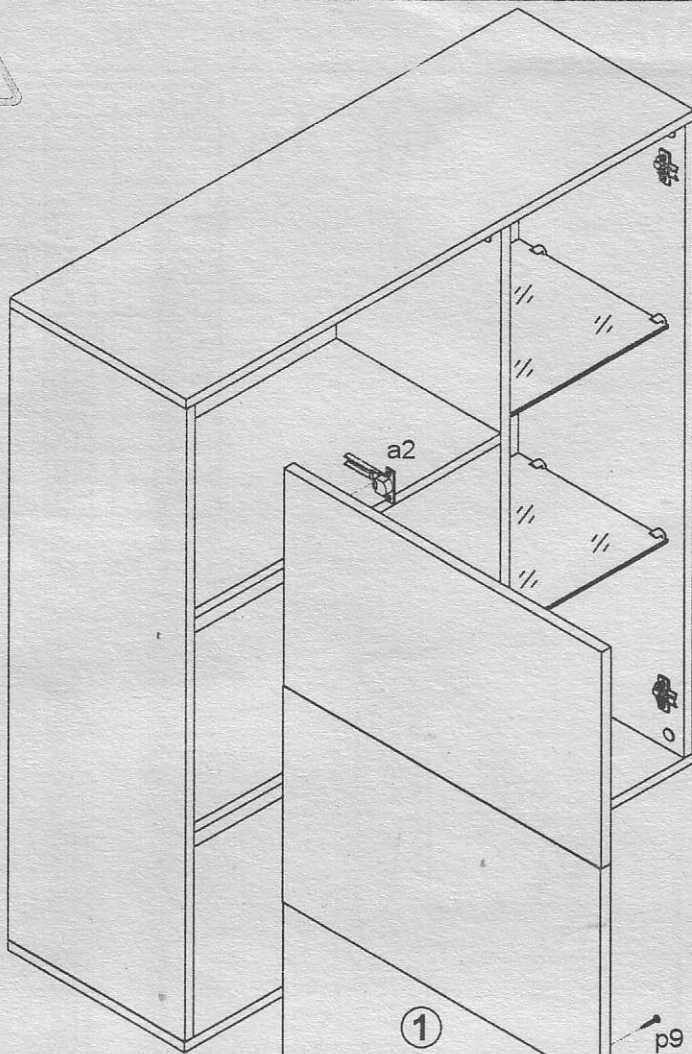

S164-SFW1W1D/11/10P

A	B	C	D	
1	S116-107	1022	330	1/2
2	S116-108	1022	330	1/2
3	S116-109	1022	310	1/2
4	S116-205	950	330	1/2
5	S116-206	950	330	1/2
6	S116-302	325	280	1/2
7	S116-303	575	310	1/2
8	S116-905	1032	339	2/2
9	S116-906	1032	588	2/2
10	S164-004	596	1050	2/2
11	S164-006	1050	346	2/2
12	qb30\2			1/2

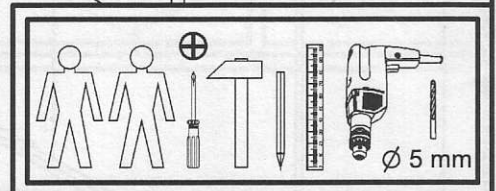
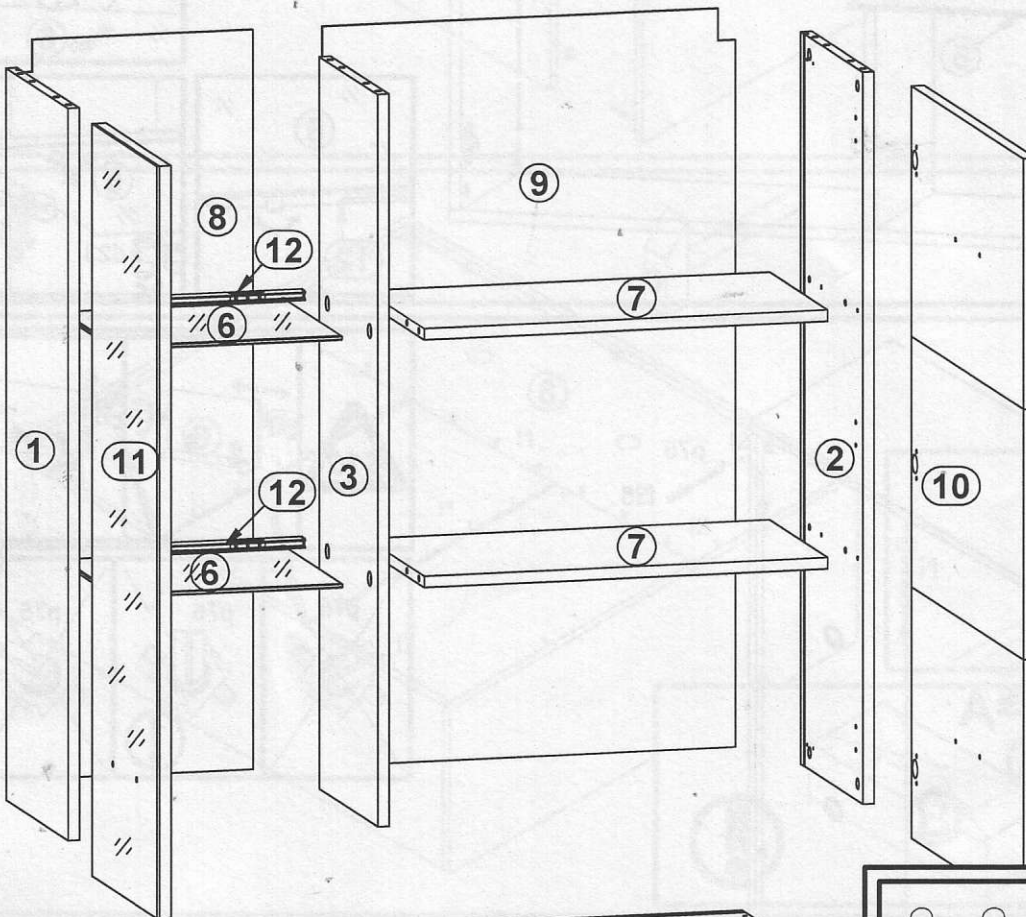
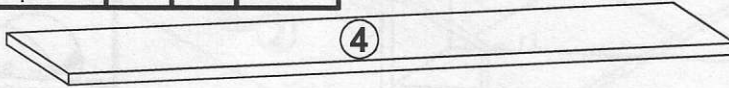
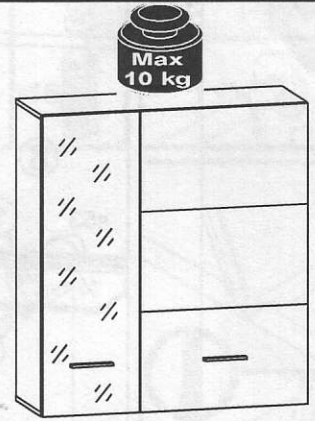

3x a2	2x a44	3x b1	2x b35	2x c253\3	8x d23	8x φ6.0x11 mm e36	20x φ8x30 mm f1	2x φ1.0x50 mm f35
30x l1	10x l2	1x n38\L	1x n38\P	4x stihkon o21	2x φ6.5φ10x5.2mm o27	2x o43\7	4x φ4x30 mm p21	4x φ3.5x15 mm p51
2x φ4x12 mm p59	2x φ6x60 mm p75	2x φ4x30 mm p9	20x φ1.5x12mm #16 r1	20x r16	18x φ16 s2	2x s53		

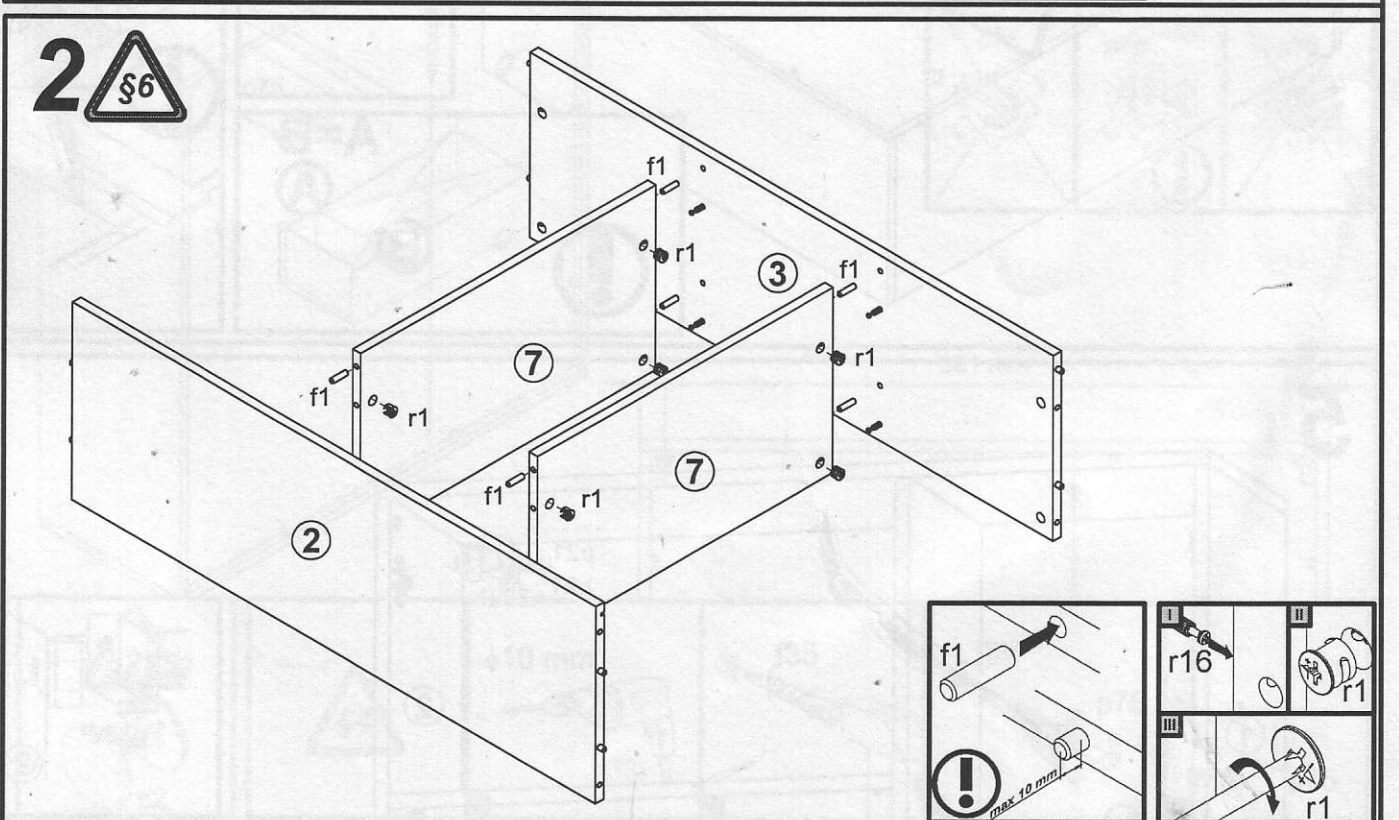
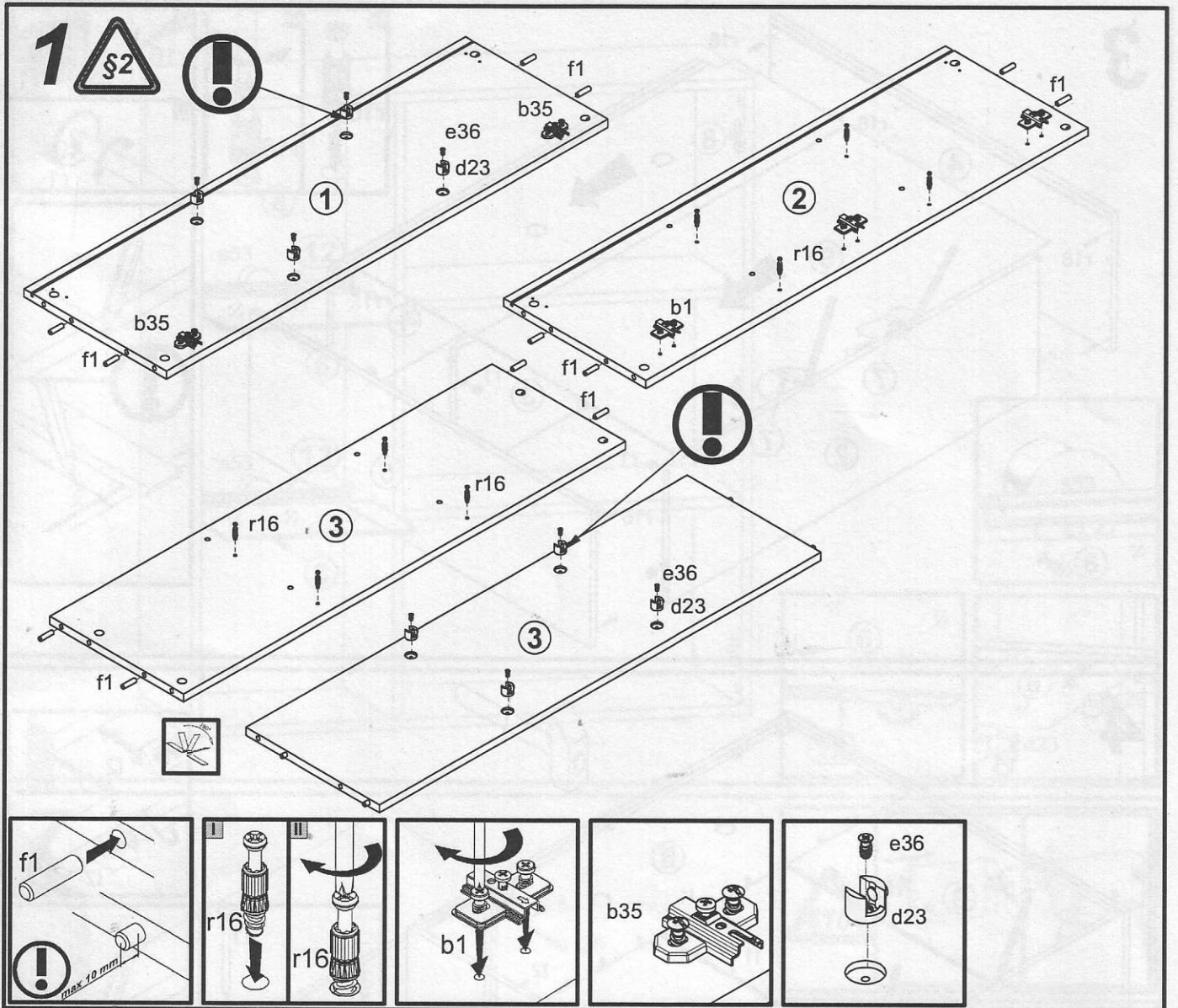

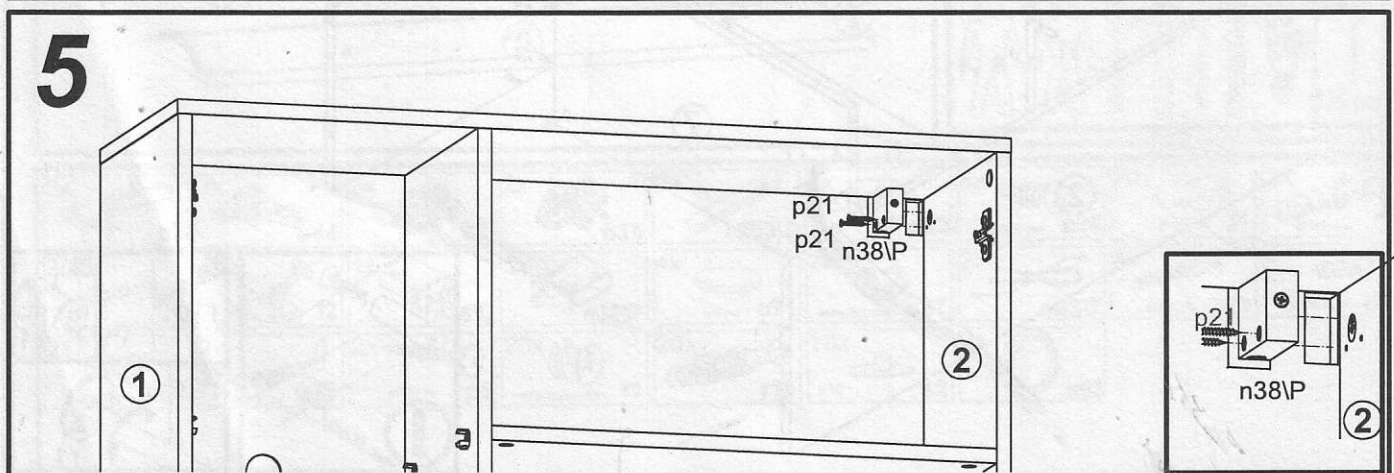
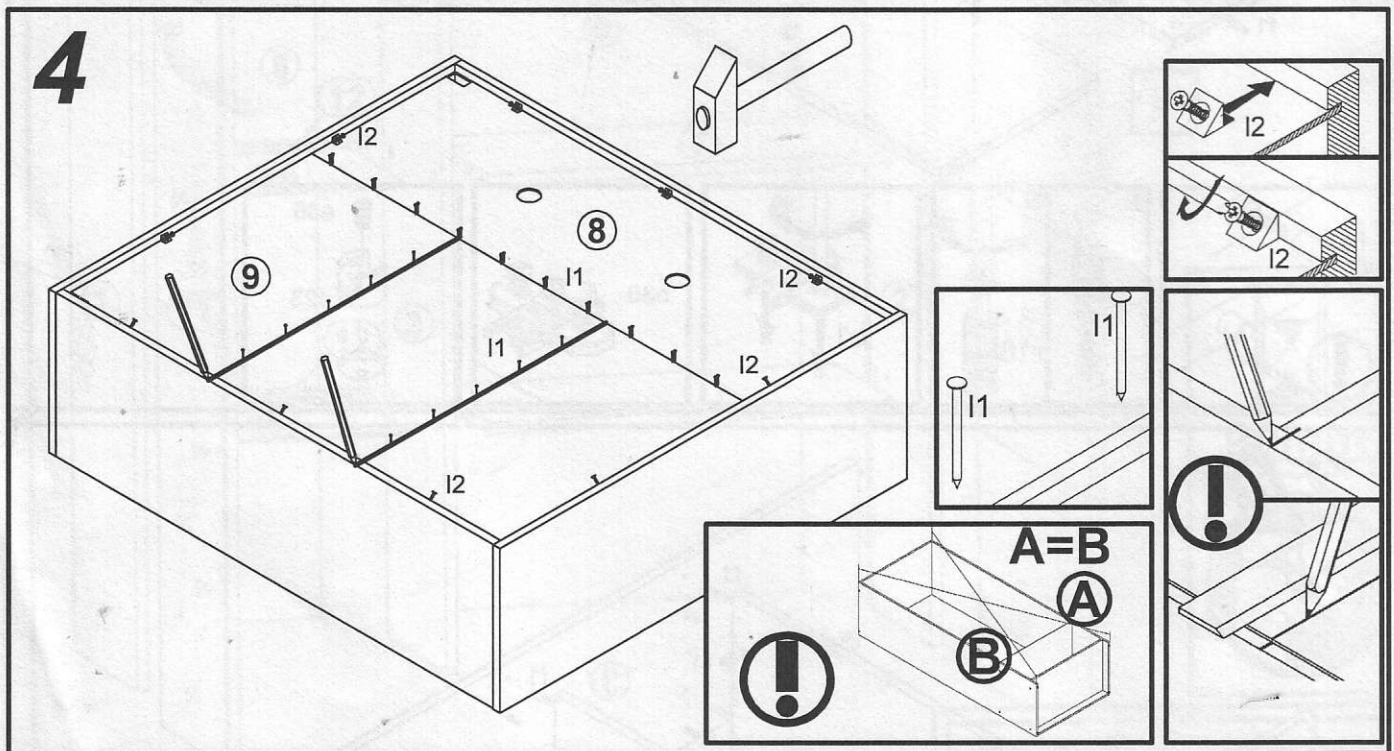
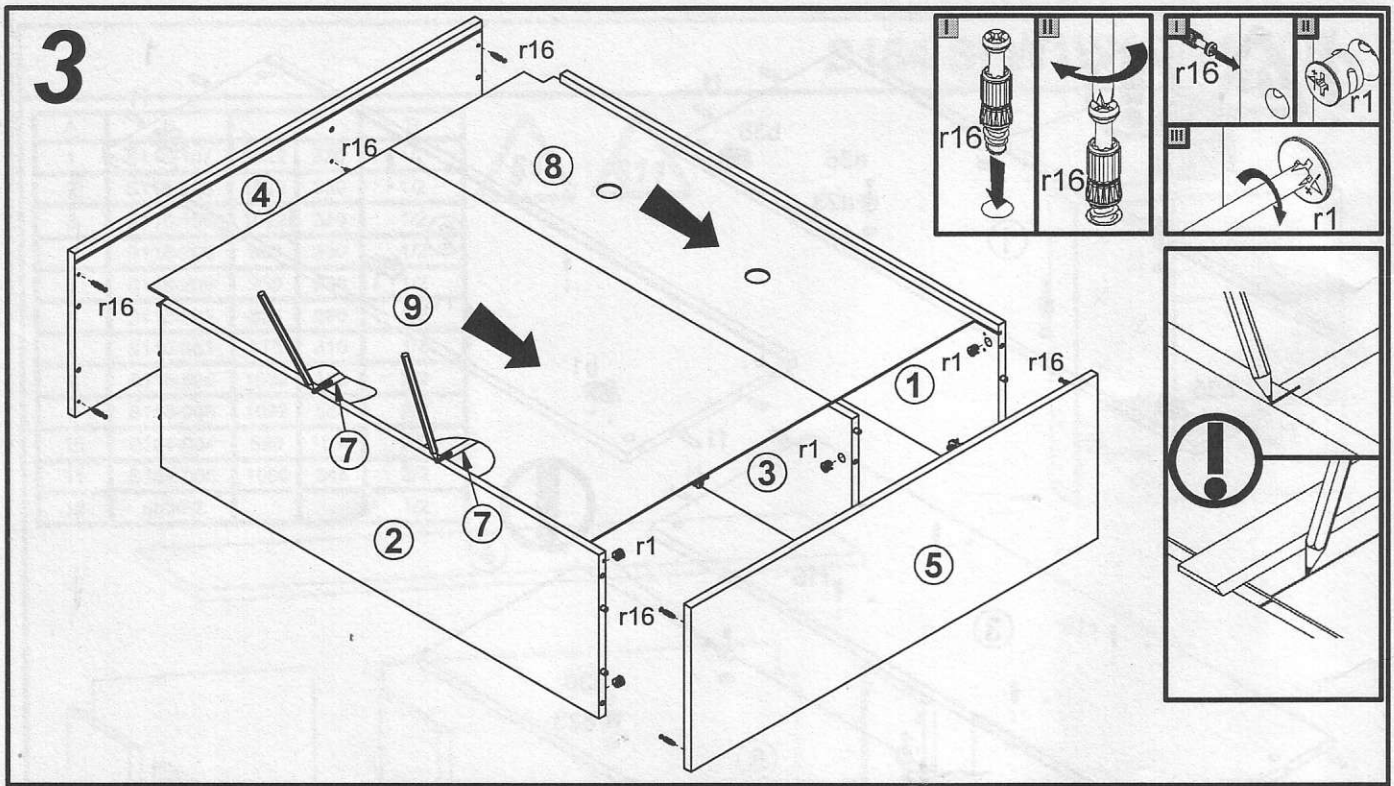

6

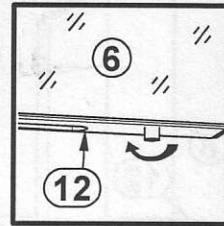
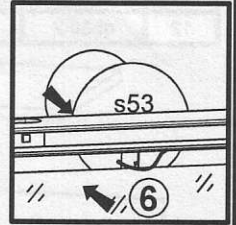
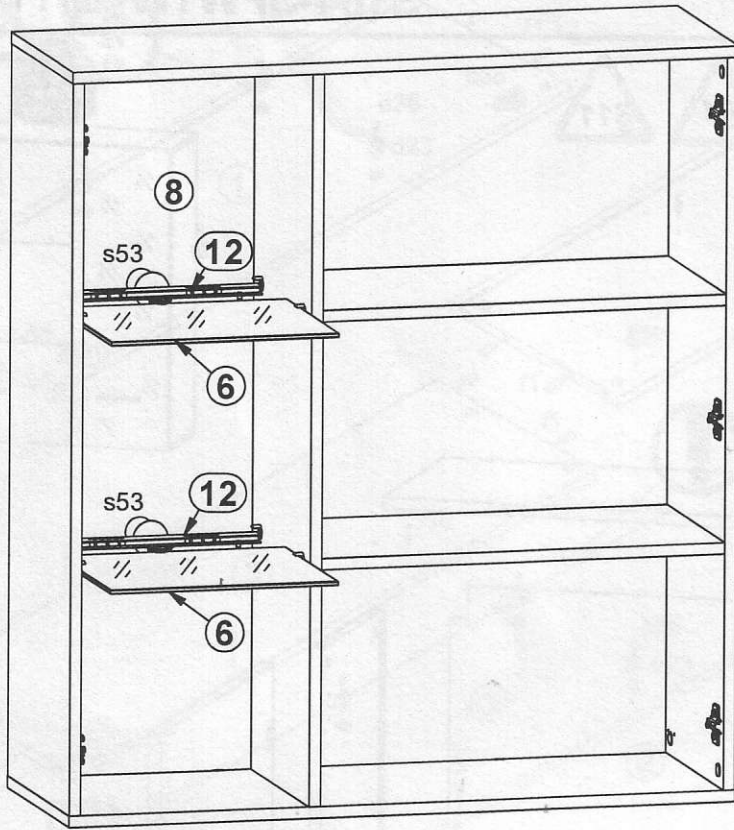

7

